

Package Dimensions

3.5x2.8mm SMD CHIP LED LAMP



ATTENTION
OBSERVE PRECAUTIONS
FOR HANDLING
ELECTROSTATIC
DISCHARGE
SENSITIVE
DEVICES

EA3528PBC

BLUE

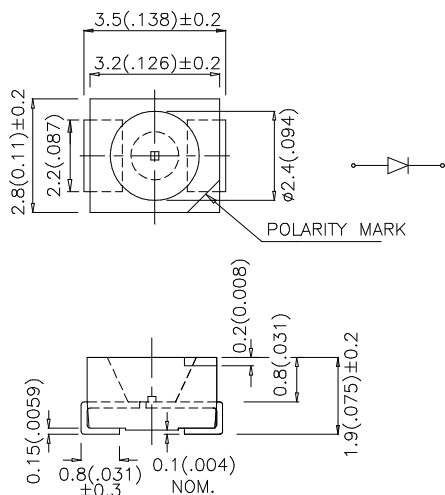

Features

- SINGLE COLOR.
- SUITABLE FOR ALL SMT ASSEMBLY AND SOLDER PROCESS
- AVAILABLE ON TAPE AND REEL.
- IDEAL FOR BACKLIGHT
- PACKAGE : 1500PCS / REEL.

Notes:

1. All dimensions are in millimeters (inches).
2. Tolerance is ±0.25(0.01") unless otherwise noted.
3. Specifications are subject to change without notice.

Description

The Blue source color devices are made with InGaN on SiC Light Emitting Diode.

Static electricity and surge damage the LEDs.

It is recommended to use a wrist band or anti-electrostatic glove when handling the LEDs.

All devices, equipment and machinery must be electrically grounded.

Selection Guide

| Part No. | Emitting Color +Material | λD(nm) | Lens Type | Iv (mcd) @ 20 mA | | Viewing Angle |
|-----------|-----------------------------|--------|-------------|---------------------|------|------------------|
| | | | | Min. | Typ. | 2 θ 1/2 |
| EA3528PBC | InGaN | 470 | WATER CLEAR | 18 | 60 | 120° |

Note:

1. θ1/2 is the angle from optical centerline where the luminous intensity is 1/2 the optical centerline value.

DATA NO :EA0107

REV NO :V2

DATE :MAR/05/2004

Electrical / Optical Characteristics at $T_A=25^\circ\text{C}$

| Symbol | Parameter | Device | Typ. | Max. | Units | Test Conditions |
|-------------------------|-------------------------|--------|------|------|---------------|--------------------------------|
| λ_{peak} | Peak Wavelength | Blue | 468 | | nm | $I_F=20\text{mA}$ |
| λ_D | Dominate Wavelength | Blue | 470 | | nm | $I_F=20\text{mA}$ |
| $\Delta\lambda_{1/2}$ | Spectral Line Halfwidth | Blue | 25 | | nm | $I_F=20\text{mA}$ |
| C | Capacitance | Blue | 65 | | pF | $V_F=0\text{V}; f=1\text{MHz}$ |
| V_F | Forward Voltage | Blue | 3.65 | 4.2 | V | $I_F=20\text{mA}$ |
| I_R | Reverse Current | Blue | | 10 | μA | $V_R = 5\text{V}$ |

Absolute Maximum Ratings at $T_A=25^\circ\text{C}$

| Parameter | Blue | Units |
|-------------------------------|--|-------|
| Power dissipation | 126 | mW |
| DC Forward Current | 30 | mA |
| Peak Forward Current [1] | 160 | mA |
| Reverse Voltage | 5 | V |
| Operating/Storage Temperature | -40°C To $+85^\circ\text{C}$ | |

Note:

1. 1/10 Duty Cycle, 0.1ms Pulse Width.

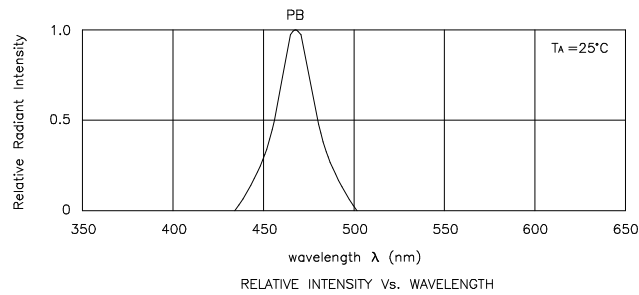

Blue EA3528PBC

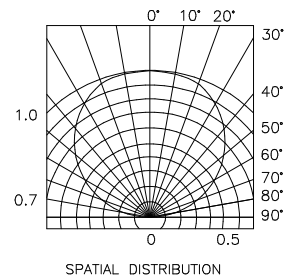
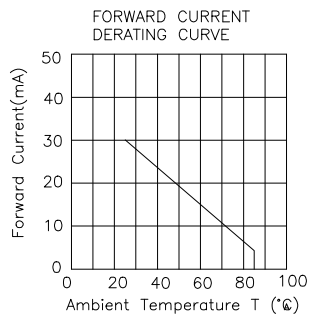
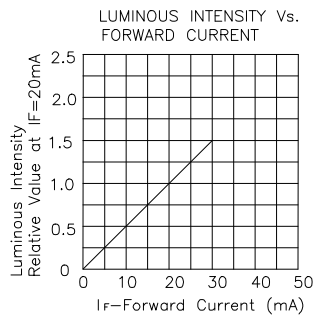
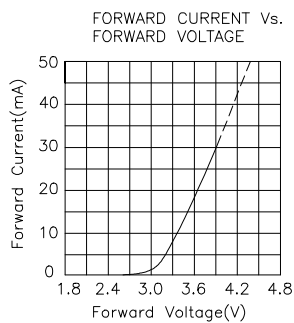

DATA NO :EA0107

REV NO :V2

DATE :MAR/05/2004

EA3528PBC

SMT Reflow Soldering Instructions

Number of reflow process shall be less than 2 times and cooling process to normal temperature is required between first and second soldering process.

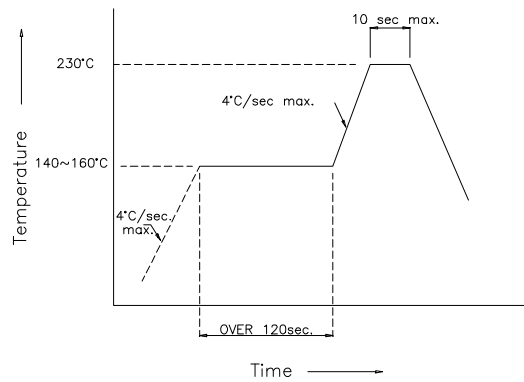

Recommended Soldering Pattern (Units : mm)

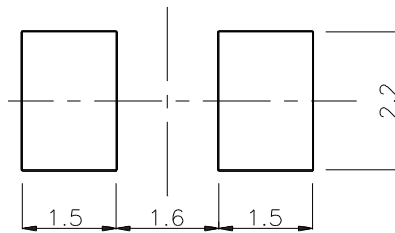

Tape Specifications (Units : mm)

